

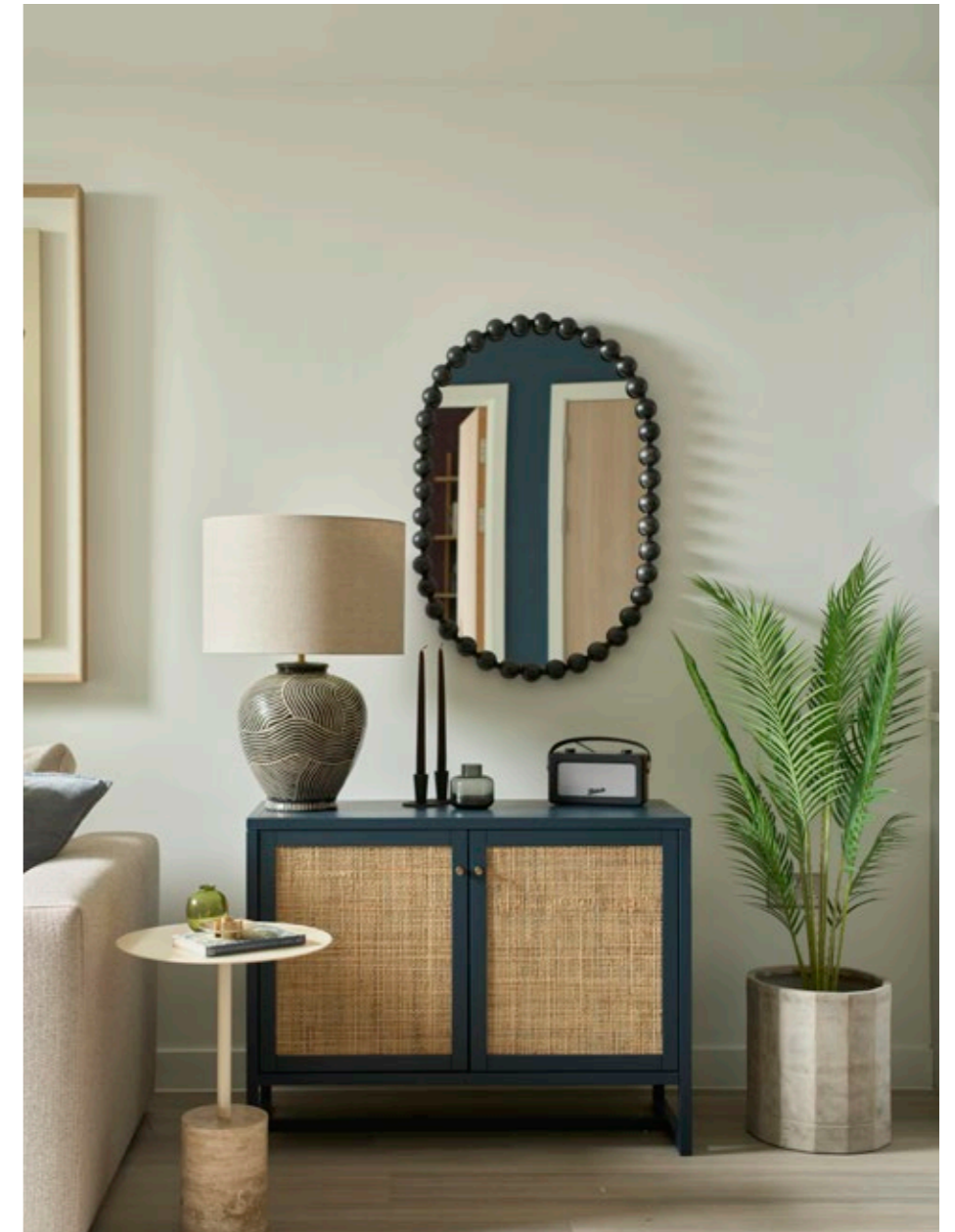

APARTMENT 5-A



NEW VIC
MANCHESTER



Our stunning apartments are available
furnished or unfurnished.





3 BEDROOM

APARTMENT TYPE 5-A

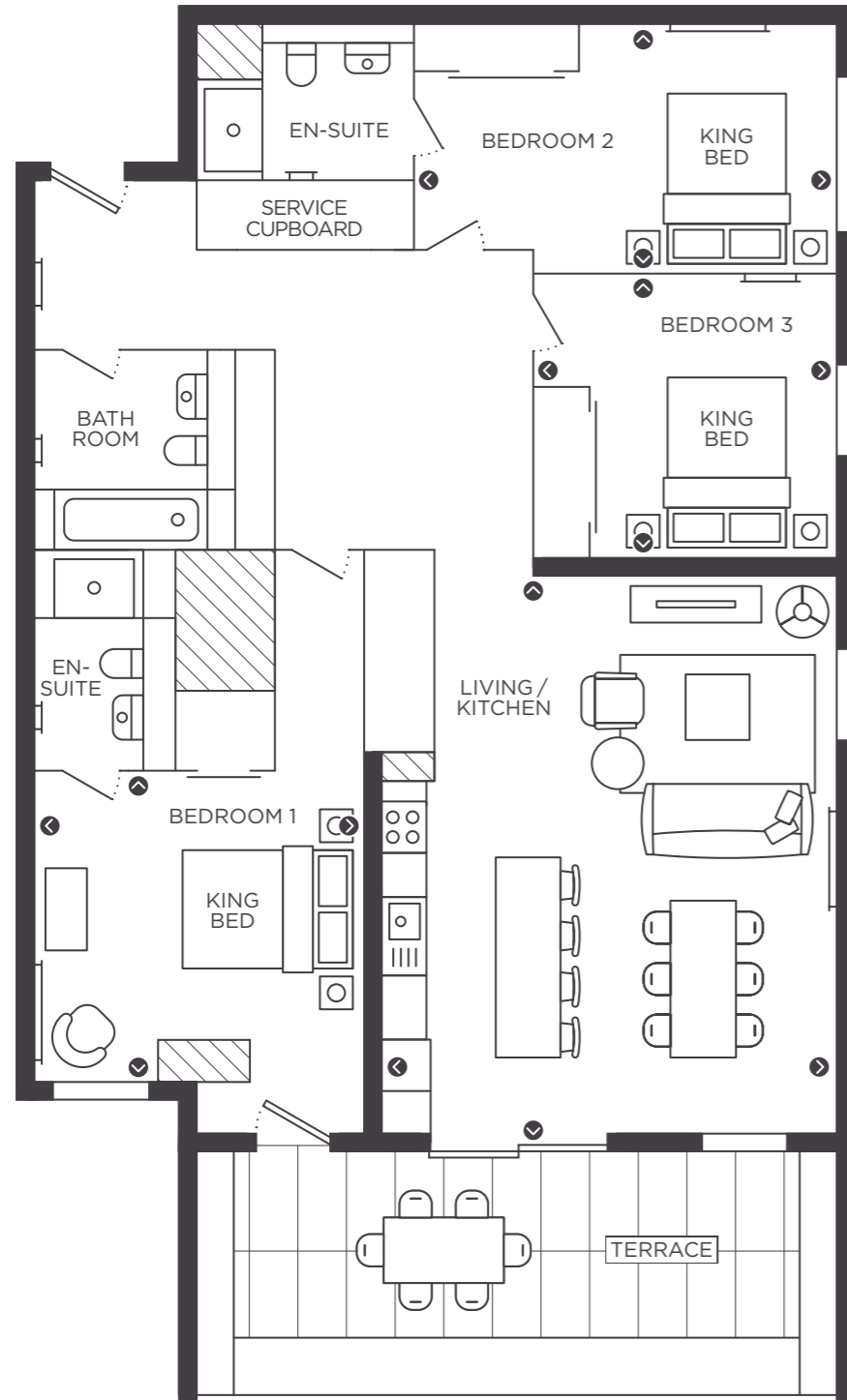

TOTAL

116.7 SQ M | 1,257 SQ FT

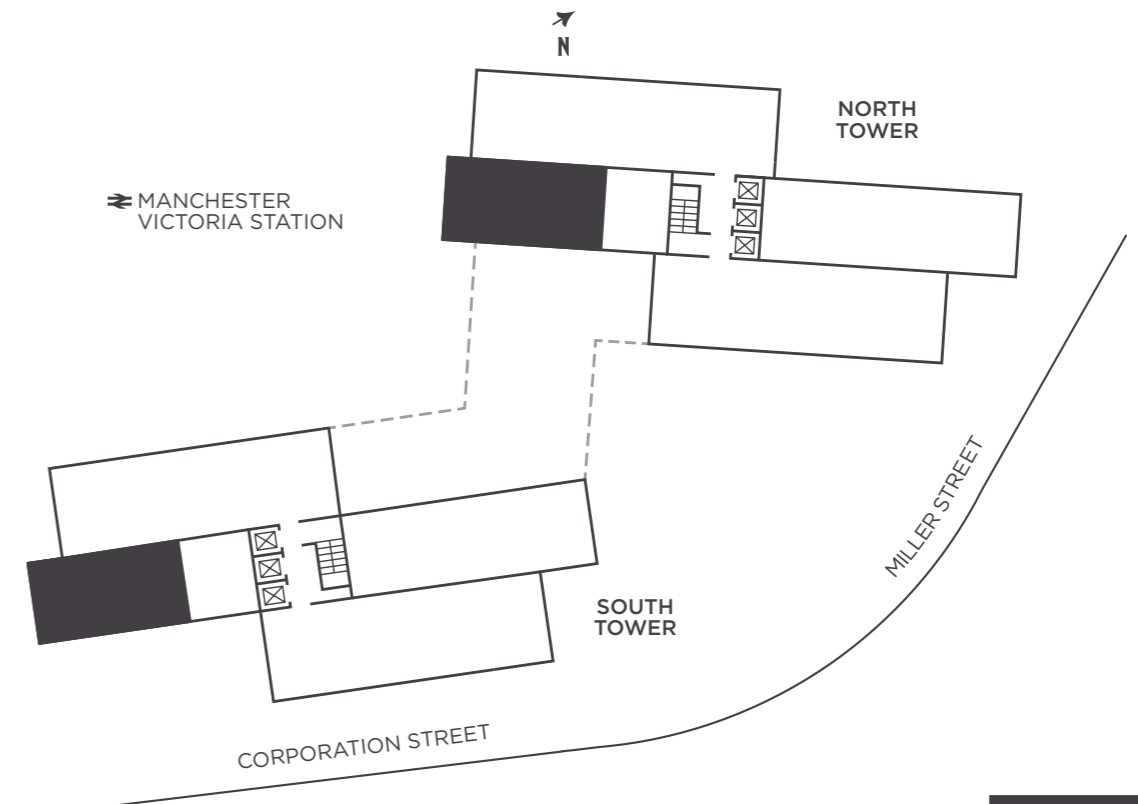

ROOM	DIMENSIONS
LIVING ROOM / KITCHEN	5.45 x 6.29m
BEDROOM 1	2.28 x 3.43m
BEDROOM 2	4.90 x 2.91m
BEDROOM 3	3.53 x 3.22m

